

VIBRATION DAMPING AND SOUND INSULATION

VIBRAFON multipad bearing – vibration-damping bearing for construction sections, by means of a multipad system

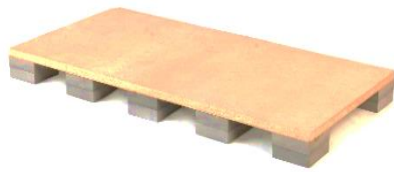

VIBRAFON Multipad bearing	Thickness*	Cushioning frequency
Sylomer/Sylodyn	12 mm	As of 16-20/14-17 Hz
Sylomer/Sylodyn	25 mm	As of 10-15/10-13 Hz
Sylomer/Sylodyn	37 mm	As of 9-13/8.5-12 Hz
Sylomer/Sylodyn	50 mm	As of 7.3-16/7.3-10 Hz
Sylomer/Sylodyn	75 mm	As of 5.6-7.6/5.7-6.3 Hz
Sylomer/Sylodyn	100 mm	As of 4.8-6.0/4.9-5.5 Hz
Sylomer/Sylodyn	150 mm	As of 3.8-4.9/3.9-4.5 Hz

Product description Vibrafon multipad bearing is a combination product, which consists of vibration-dampening pads that are glued on a carrier, which can be applied between two architectural constructions for limiting vibration transmission.

- Properties**
- Exceedingly good vibration-insulating properties
 - Easily and quickly installed
 - Cost-effective solution
 - Different thicknesses are possible
 - Service life of more than 50 years

Application In many cases, VIBRAFON multipad bearings are installed in the foundations of a building, so as to prevent vibrations from the surroundings and other building sections (for instance caused by railroad tracks, machines, etc.).

- Required information**
- For a good expert opinion, the following information is necessary:
- Required cushioning frequency
 - Information with regard to the static and maximum load at each application position, both in a horizontal and in a vertical direction
 - Maximum dynamic loads
 - Drawings of the building sections in which the products are to be used
 - Details of the construction in which the VIBRAFON multipad bearing is installed
 - The pile plan of the building
 - Available space and height for the product
 - Fire requirements

Dimensions

The dimensions of the combination product can differ and are dependent on the supporting construction, the occurring loads and the cushioning frequency that is to be achieved.

Schematic diagram

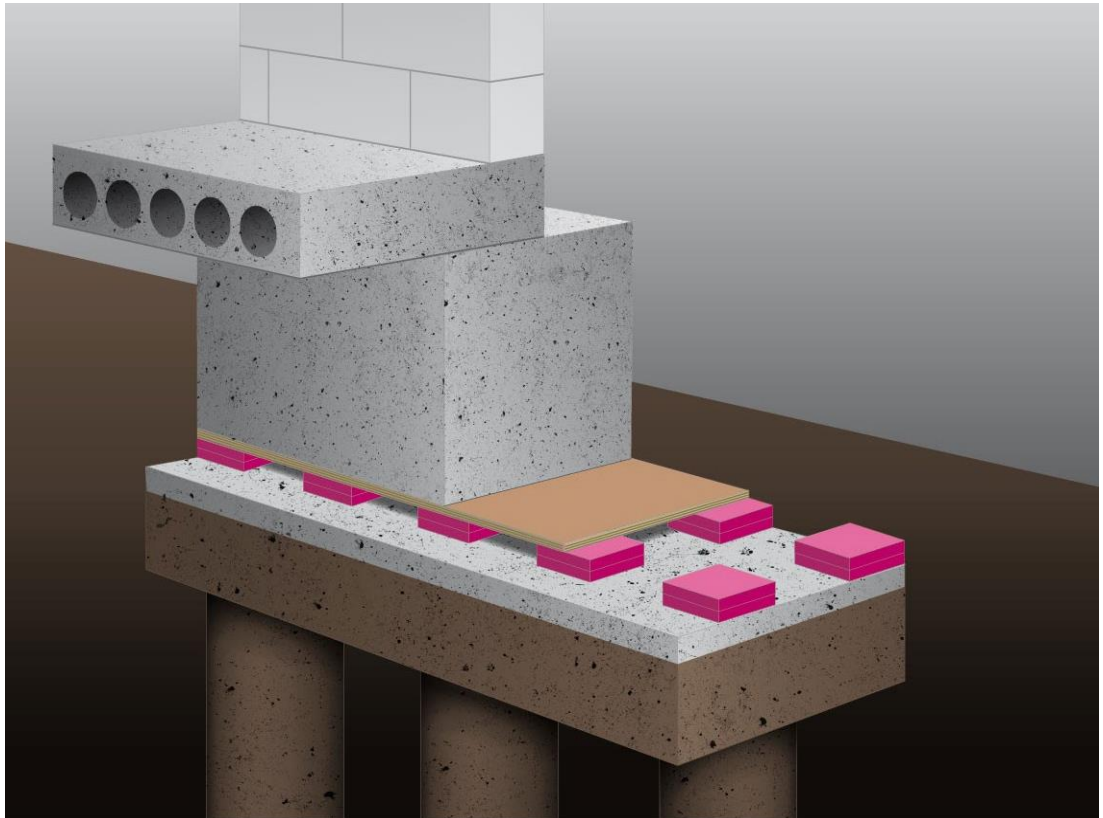

Illustrations

